

Rec speed Area
124 x 20 mm
for lab eling

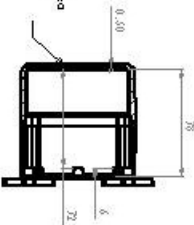

A-A

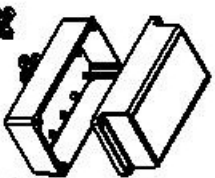
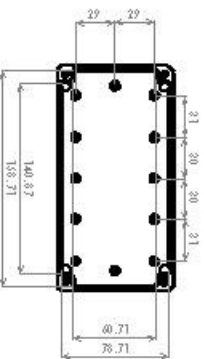
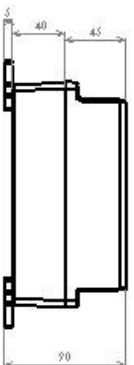

www.lincolnhinns.com

185x85x85mm Sealed Enclosure
comes with stainless steel lid-fixing
screws, EPDM O-ring seal and pcb
mounting screws.

3 variants:

WP1658585 mat. is ABS UL-94V0
WPCT1658585 as above with clear top.
WPPC1658585 mat. is poly-carbonate
Optional mounting feet WMF-1 (pk 4)